

CARDIFF'S HOME FOR
STYLISH SALES
& LETTINGS

JeffreyRoss



COLUM ROAD
CATHAYS

COLUM ROAD

CATHAYS, CF10 3EF - £129 PCM PCM

1 bedroom(s) 1 bathroom(s) 0.00 sq ft

JeffreyRoss are delighted to offer the Newman Hall, Student Halls of Residence in the heart of Cathays. Located on Colum Road, the block is just a 7 minute walk from the Students Union and 12 minutes from the City Centre so perfectly located in the thick of the action in Cathays yet tucked away in a quiet corner and opposite Bute Park (and accessed via Nazareth House.) The block offers a host of benefits with two large common rooms, three kitchens, utility room, off-road parking (for an additional charge) and communal gardens. Each room is well-equipped with ensuite shower room, bed, wardrobe and desk. A brilliant student block and one we're delighted to bring to the market.

EPC RATING of C

A holding fee of one weeks' rent will be payable to secure the dwelling. This will be deducted from the final balance payable upon moving into the dwelling, subject to a successful application. Jeffrey Ross Limited reserves the right to retain this payment should the applicant have provided false or misleading information at the time of applying for the dwelling or failed to take reasonable steps to enter into the Standard Occupation Contract.



Energy Efficiency Rating		
	Current	Potential
<i>Very energy efficient - lower running costs</i>		
(92 plus) A		
(81-91) B		
(69-80) C		
(55-68) D		
(39-54) E		
(21-38) F		
(1-20) G		
<i>Not energy efficient - higher running costs</i>		
England & Wales	EU Directive 2002/91/EC	

Newman Hall, Cathays

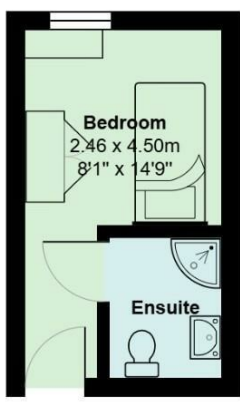

Total Area: 10.7 m² ... 115 ft²
All measurements are approximate and for display purposes only

PROPERTY SPECIALIST

Jon Hooper-Nash
jon@jeffreycross.co.uk



Director